

KeraTwin®K20

NICHT SICHTBARE BEFESTIGUNG MIT VERTIKALEM TRAGPROFIL
INVISIBLE FASTENING WITH VERTICAL BEARING PROFILE
FIXATION NON APPARENTE AVEC PROFILE PORTEUR VERTICAL

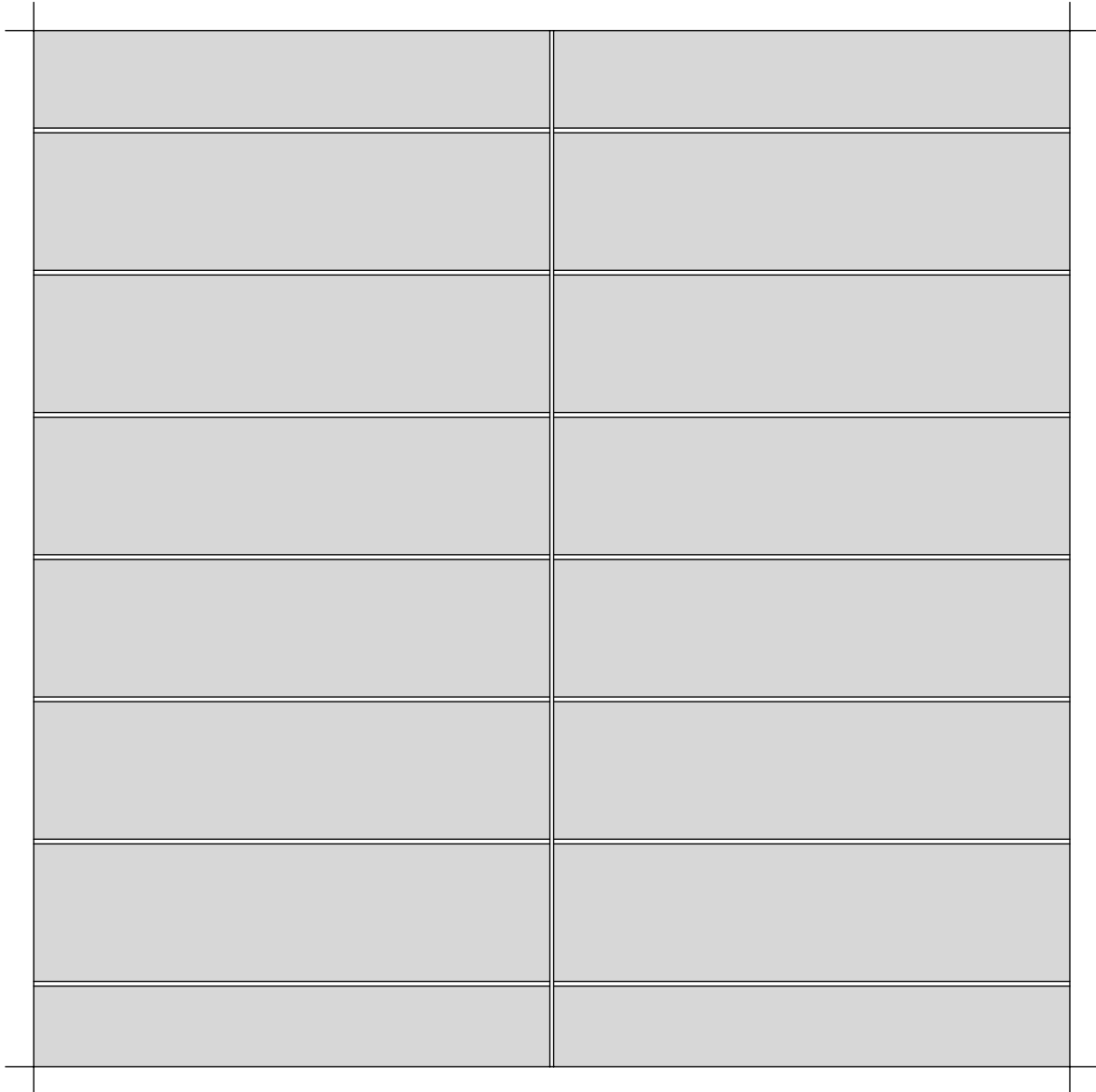

WEITERE OBJEKTSPEZIFISCHE DETAILS AUF ANFRAGE
FURTHER PROJECT-RELATED DETAILS UPON REQUEST
D'AUTRES DETAILS RELATIFS AU PROJET SUR DEMANDE

Alle Rechte vorbehalten. Außervertragliche Nutzung nur mit unserer schriftlichen Genehmigung.
All rights reserved. Noncontract use is subject to our previous written consent.
Tous droits réservés. Utilisation hors contract seulement avec notre autorisation écrite.

DEUTSCHE STEINZEUG  **AGROB BUCHTAL** AGROB BUCHTAL GmbH Architektenservice D - 92521 Schwarzenfeld
Tel. 09435 / 391 3238 e-mail: as.fassade@deutsche-steinzeug.de

STAND: Mai 2019

DIES SIND UNVERBINDLICHE KONSTRUKTIONSVORSCHLÄGE, DIE FÜR JEDES PROJEKT AUF ANWENDBARKEIT UND RICHTIGKEIT GEPRÜFT WERDEN MÜSSEN.
THESE ARE NOT BINDING CONSTRUCTION PROPOSALS WHICH HAVE TO BE VERIFIED FOR EACH INDIVIDUAL PROJECT AS REGARDS APPLICABILITY AND CORRECTNESS.
IL S' AGIT DE PROPOSITIONS DE CONSTRUCTION SANS ENGAGEMENT DE NOTRE PART QUI DOIVENT ETRE VERIFIEES POUR CHAQUE PROJET A LEUR EXACTITUDE ET FAISABILITE.

SYSTEMÜBERSICHT

SYSTEM SCHEME

SYSTEME - VUE D' ENSEMBLE

KeraTwin® K20

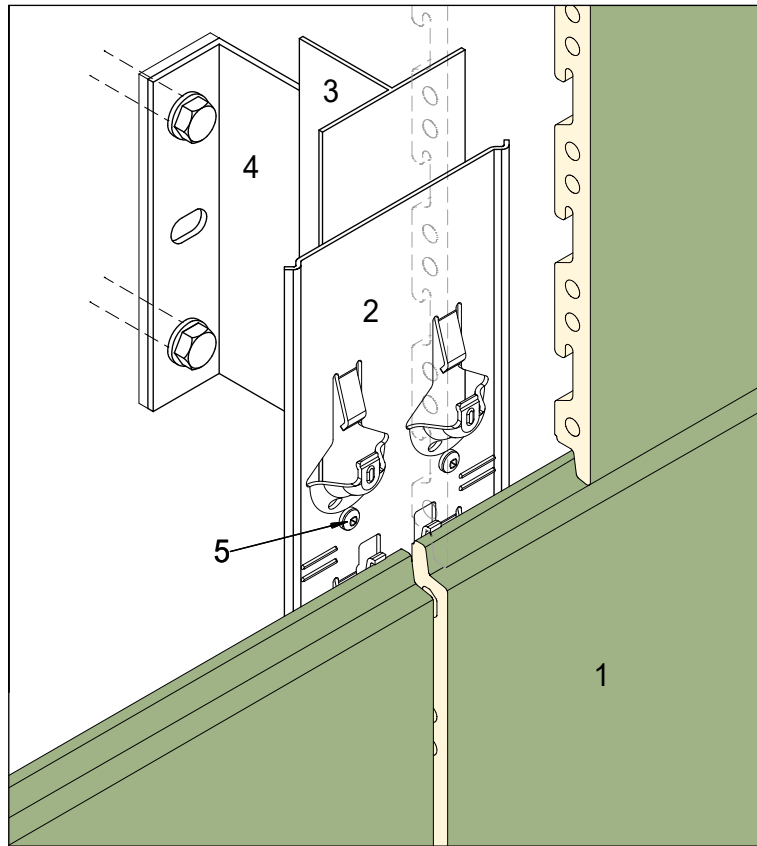

- 1 - KeraTwin® K20 FASSADENPLATTE
- 2 - VERTIKALES SYSTEMPROFIL Art.-Nr.: 620-XXX / 625-XXX
- 3 - VERTIKALES TRAGPROFIL
- 4 - ALUMINIUM-WANDHALTER
- 5 - A4-EDELSTAHLSCHRAUBE Art.-Nr.: 659-01

- 1 - KeraTwin® K20 - PANEL
- 2 - VERTICAL SYSTEM RAIL Art.-Nr.: 620-XXX / 625-XXX
- 3 - VERTICAL BEARING PROFILE
- 4 - ALUMINIUM WALL BRACKET
- 5 - A4-STAINLESS STEEL SCREW Art.-Nr.: 659-01

- 1 - DALLE KeraTwin® K20
- 2 - RAIL SYSTEME VERTICAL Art.-Nr.: 620-XXX / 625-XXX
- 3 - PROFILE PORTEUR VERTICAL
- 4 - PIECE DE SUPPORT MURAL EN ALUMINIUM
- 5 - VIS EN ACIER INOXYDABLE A4 Art.-Nr.: 659-01

SYSTEMSCHNITT HORIZONTAL

HORIZONTAL SECTION
COUPE HORIZONTALE

KeraTwin® K20

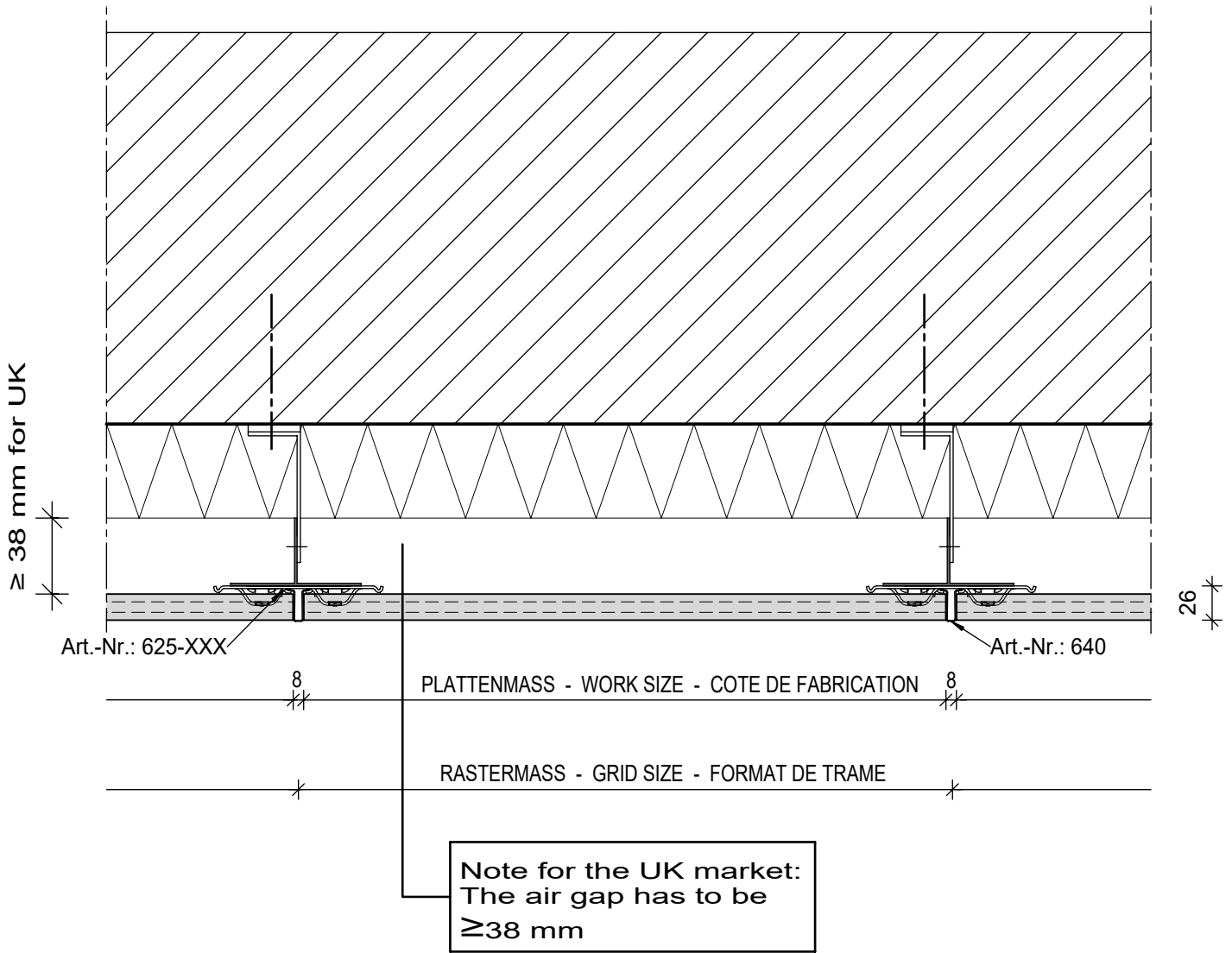

SYSTEMSCHNITT VERTIKAL

VERTICAL SECTION
COUPE VERTICALE

KeraTwin® K20

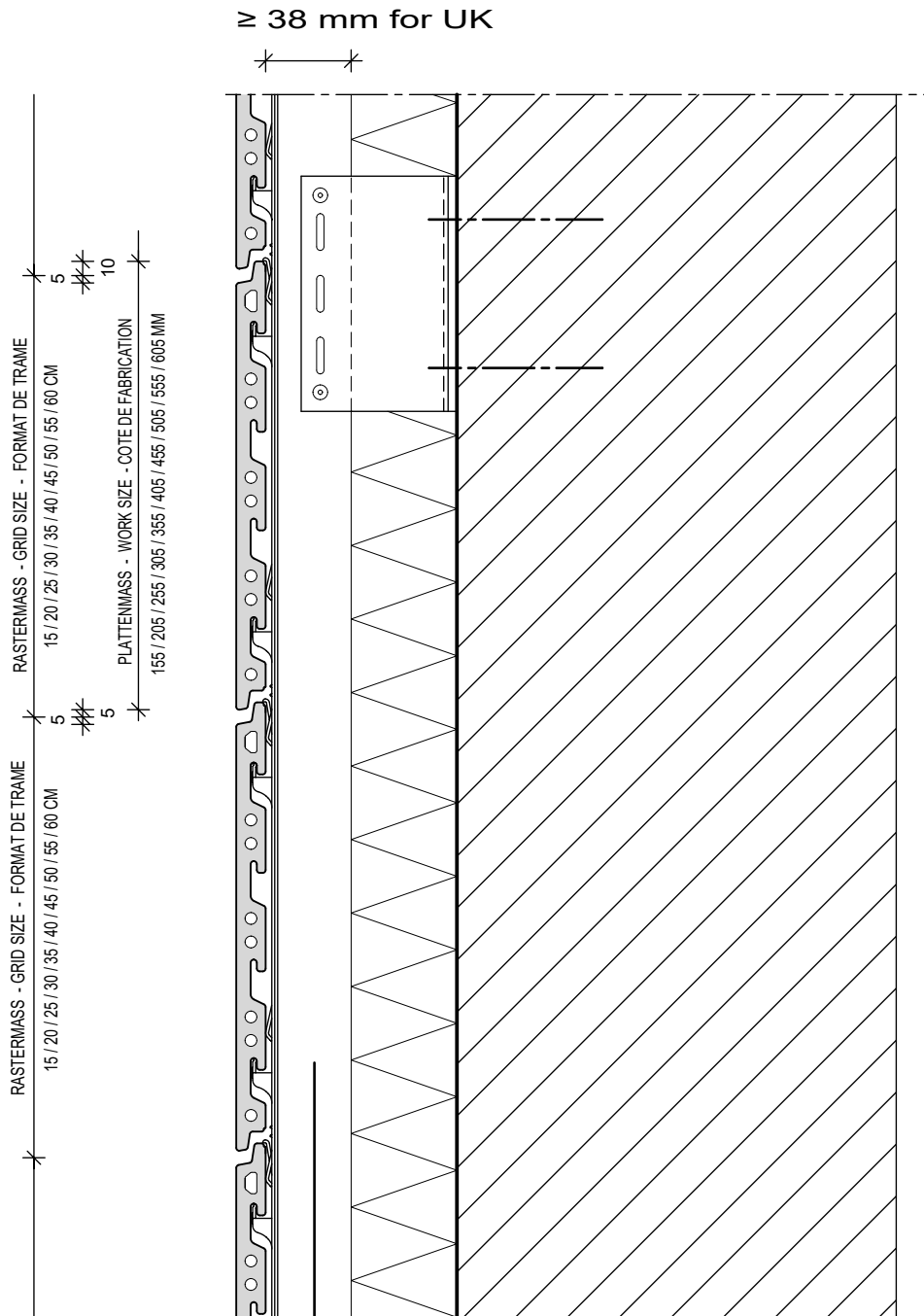

Note for the UK market:
The air gap has to be
 $\geq 38 \text{ mm}$

PROFILSTOSS

BUTT-JOINT OF PROFILES
BOUT DE PROFILE

KeraTwin® K20

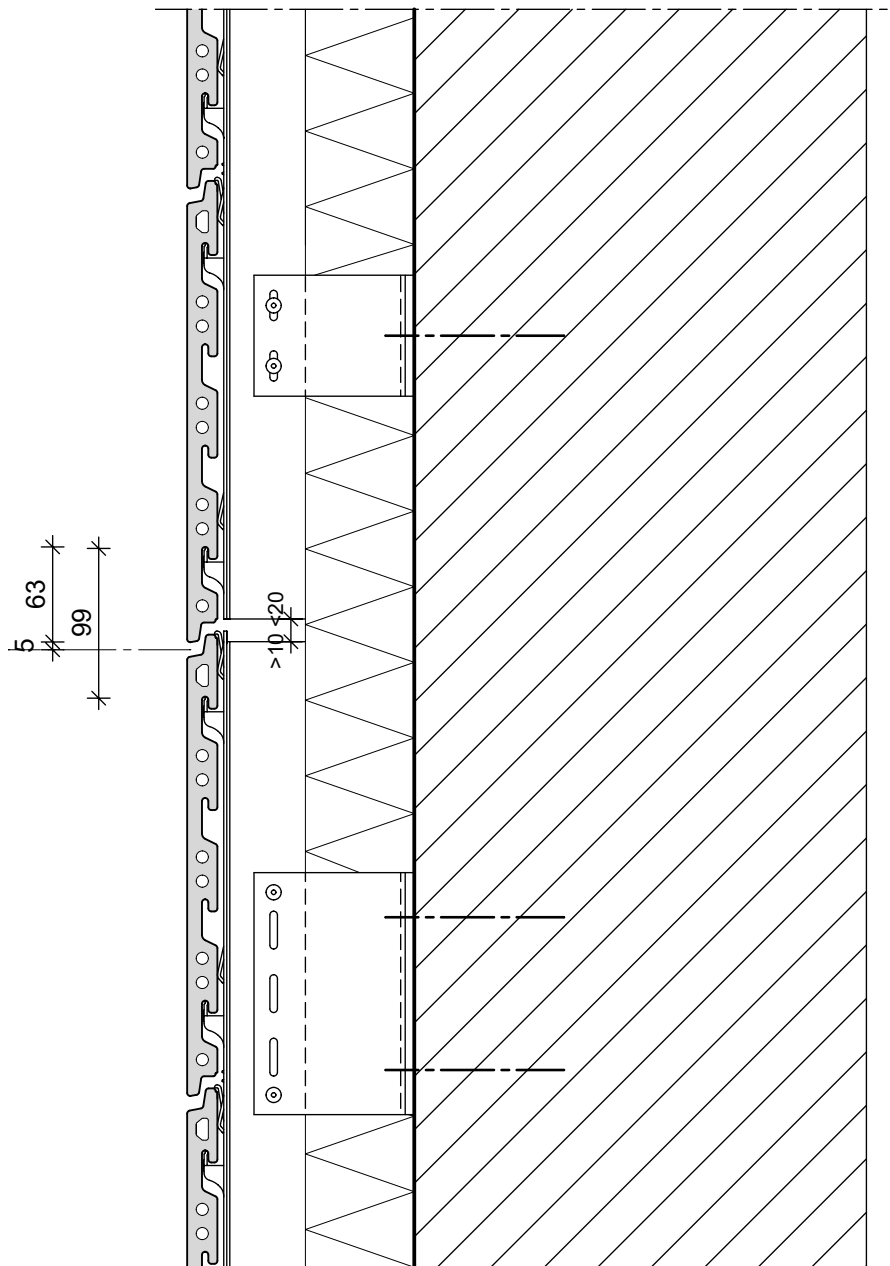

BRANDSPERRE

FIRE BARRIER
PARE-FEU

KeraTwin® K20

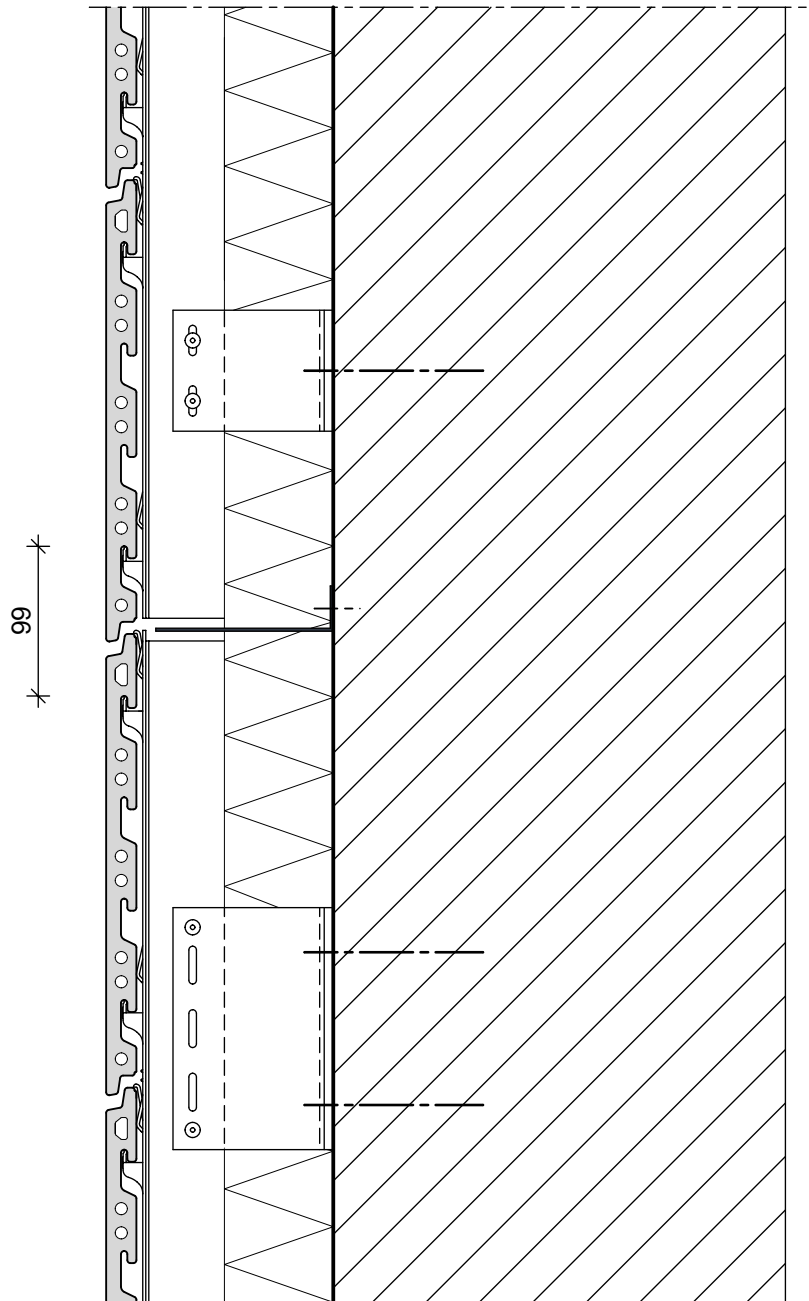

AUSSENECKE MIT GEHRUNGSPLATTEN

EXTERNAL ANGLE WITH MITRED TILES
ANGLE EXTERIEUR AVEC CARREAUX EN BIAIS

KeraTwin® K20

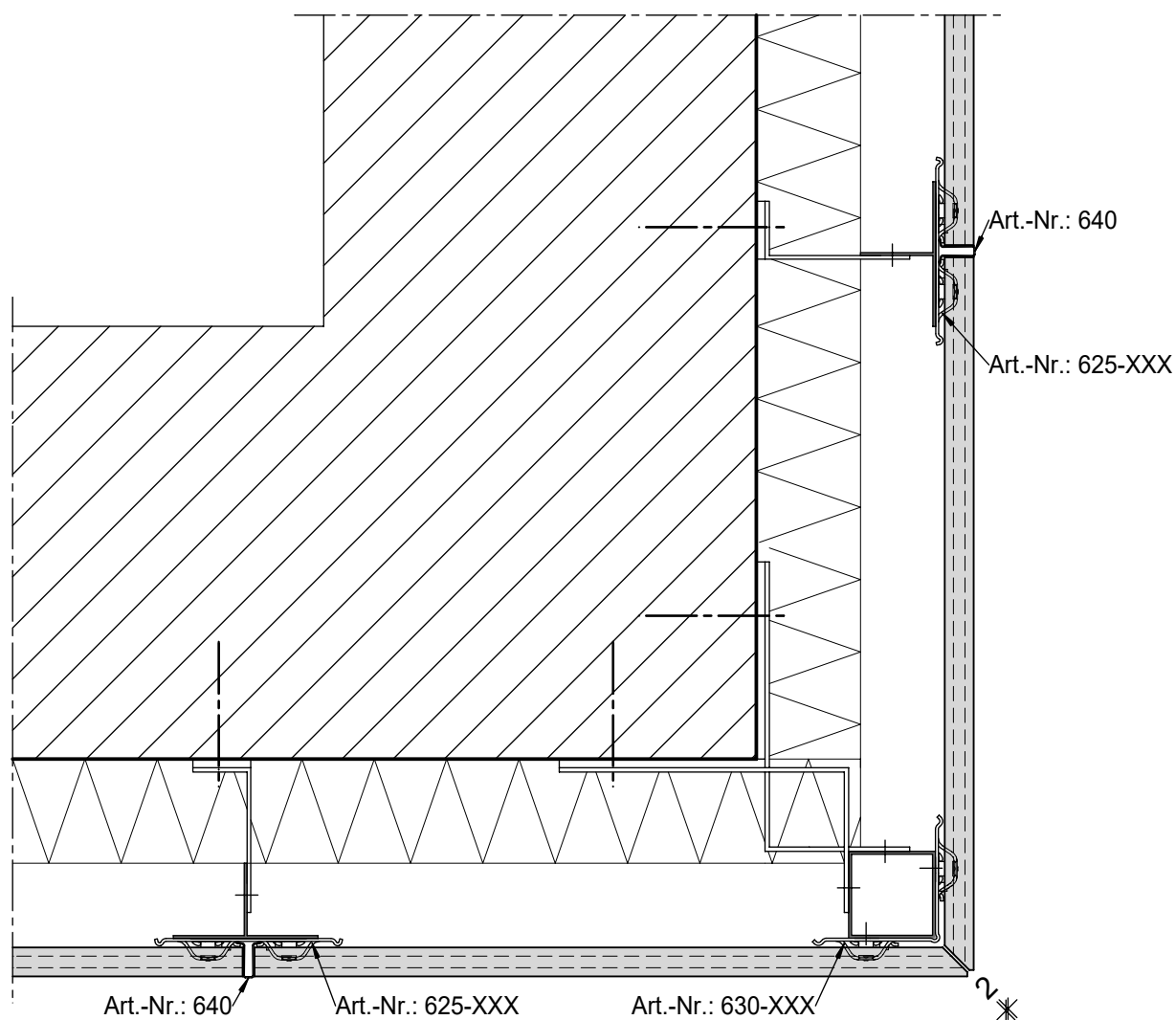

AUSSENECKE MIT ECKPROFIL

EXTERNAL ANGLE WITH CORNER PROFILE
ANGLE EXTERIEUR AVEC PROFILE D' ANGLE

KeraTwin® K20

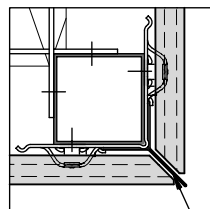
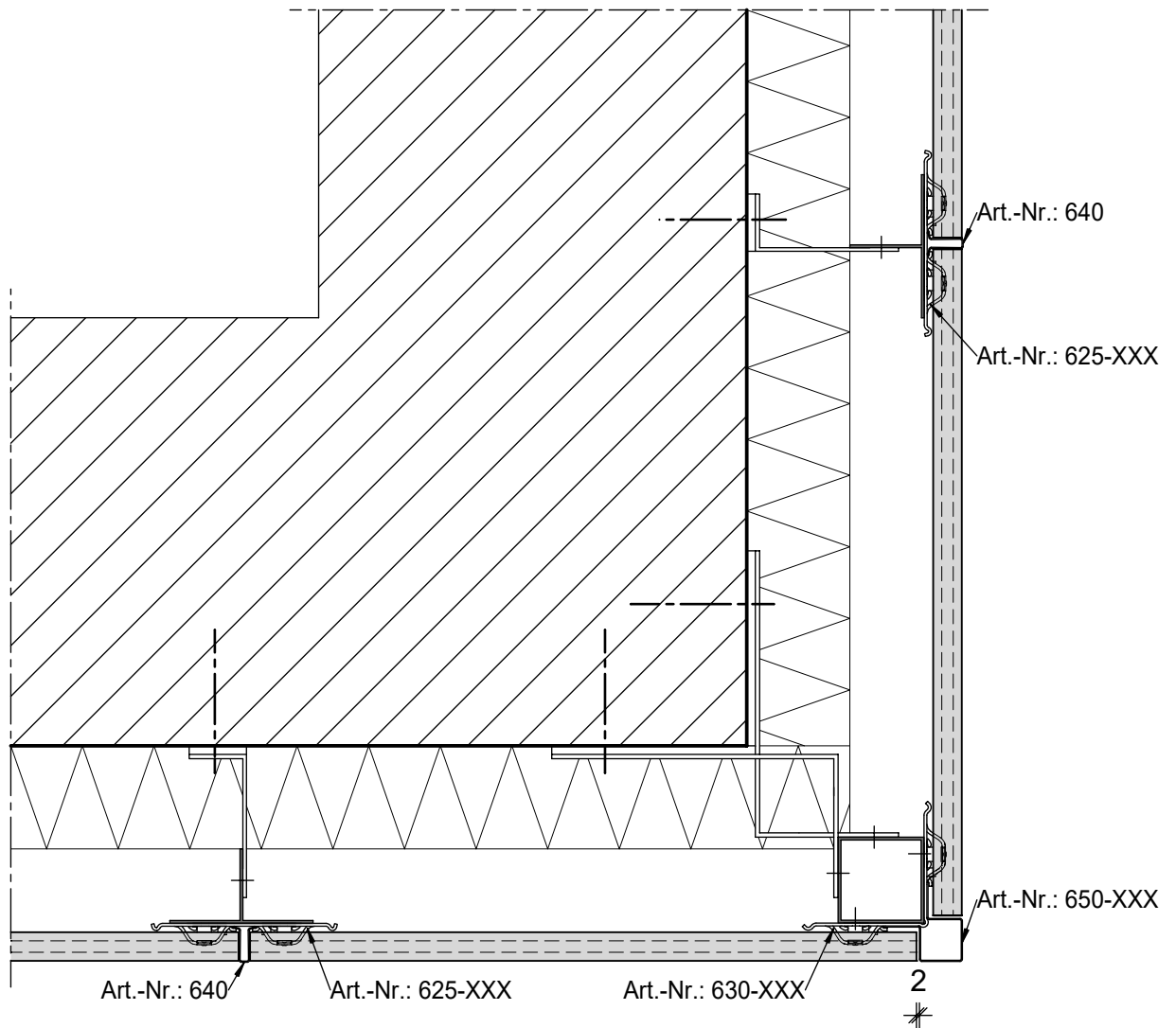

Art.-Nr.: 652-XXX

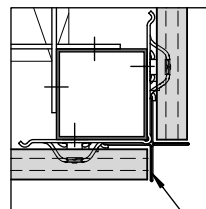

Art.-Nr.: 654-XXX

SOCKELANSCHLUSS

CONNECTION TO PLINTH

RACCORD DE SOCLE

KeraTwin® K20

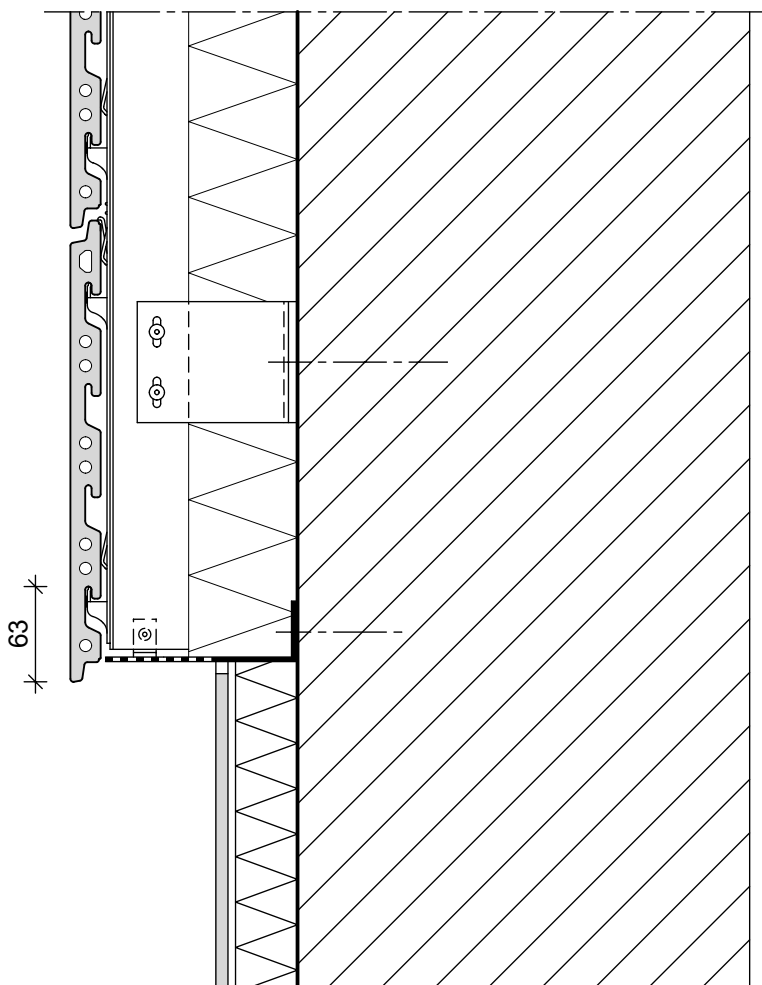

FENSTERSTURZ

WINDOW LINTEL
LINTEAU DE FENETRE

KeraTwin® K20

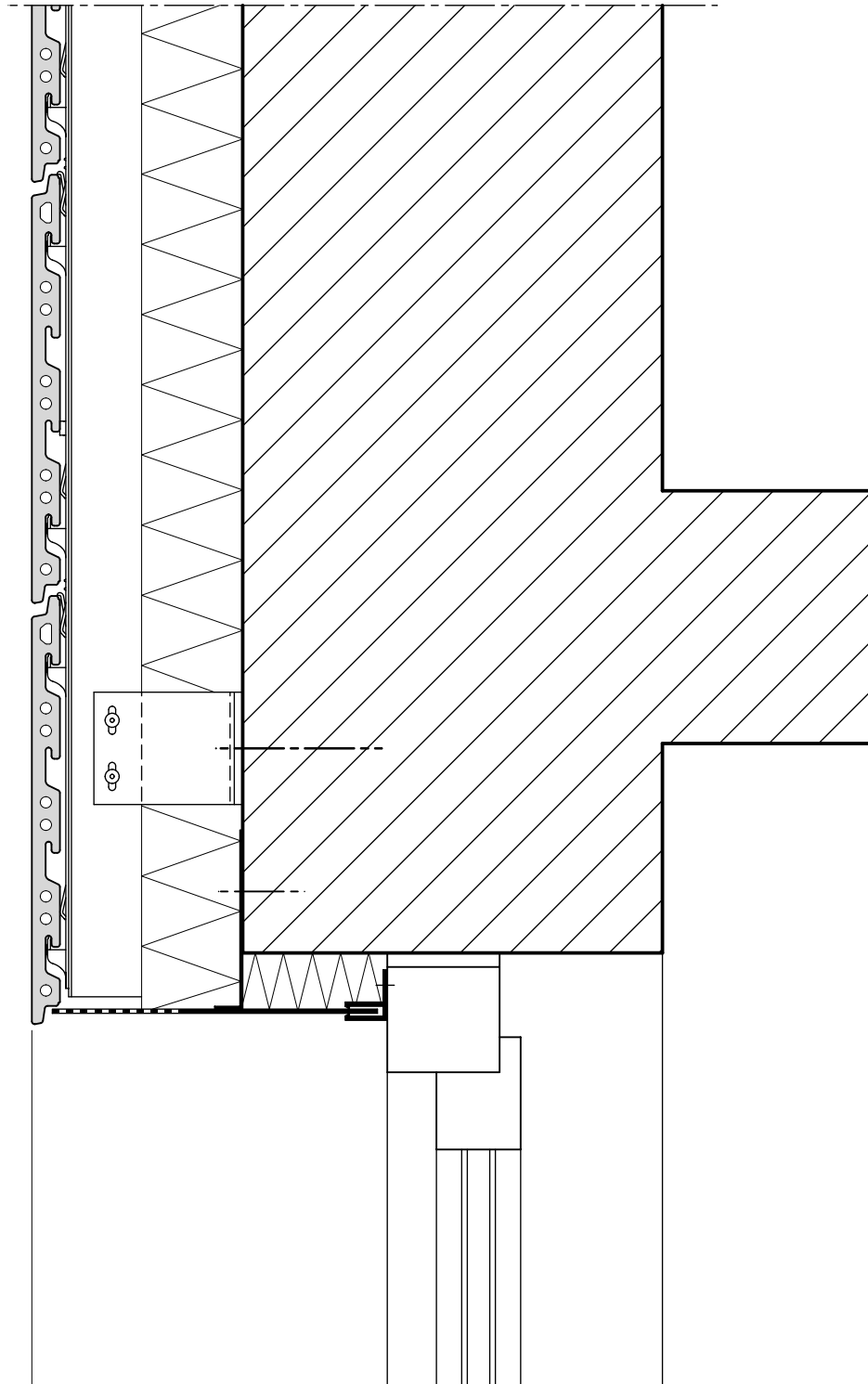

FENSTERBANK

WINDOW SILL
APPUI DE FENETRE

KeraTwin® K20

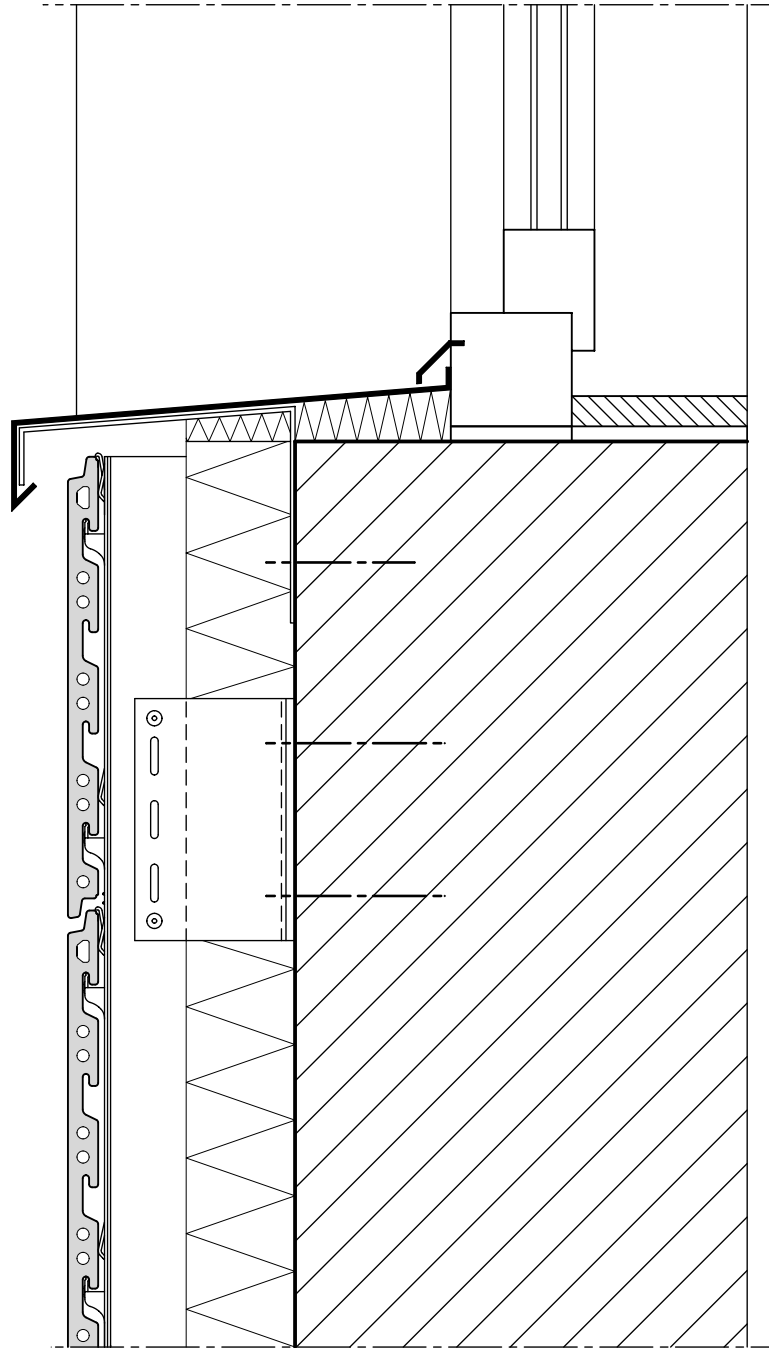

FENSTERLEIBUNG MIT BLECH

EMBRASURE OF THE WINDOW
EMBRASURE DE FENETRE

KeraTwin® K20

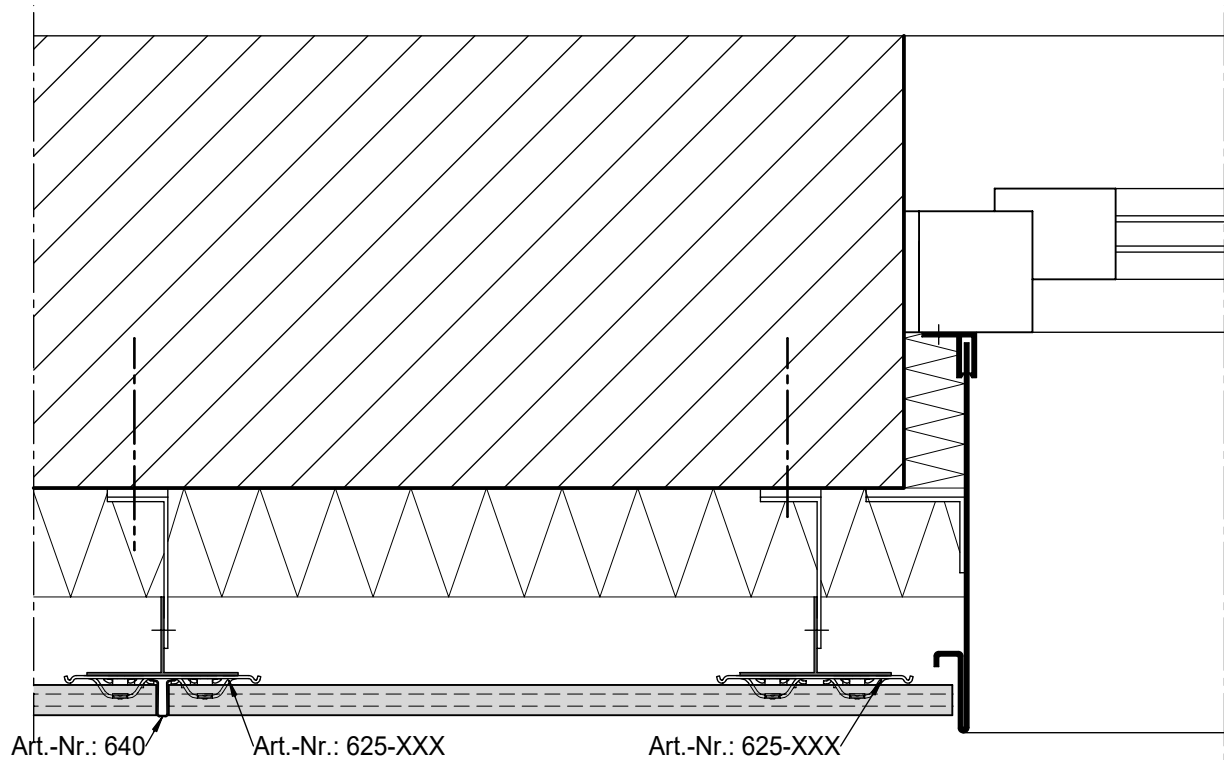

FENSTERLEIBUNG MIT KERATWIN

WINDOW EMBRASURE WITH KERATWIN

EMBRASURE DE FENETRE AVEC KERATWIN

KeraTwin® K20

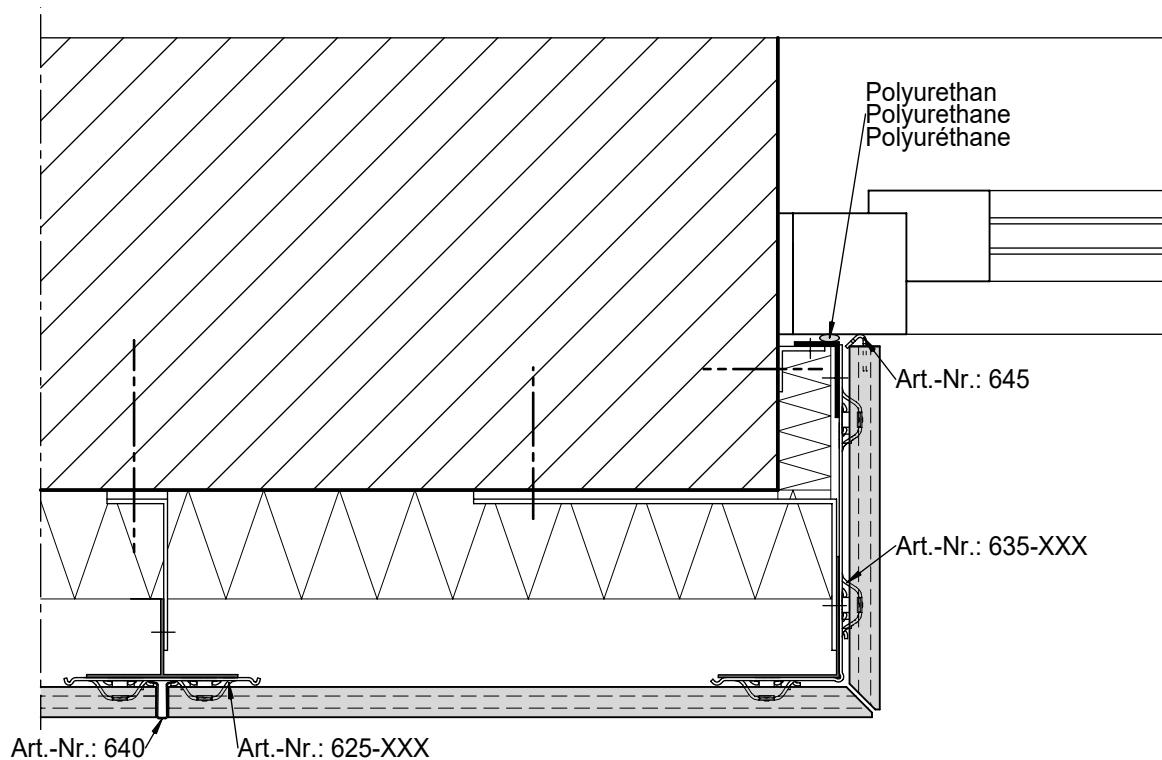

ATTIKAABSCHLUSS

COVERING OF THE ROOF PARAPET
RECOUVREMENT D'ATTIQUE

KeraTwin® K20

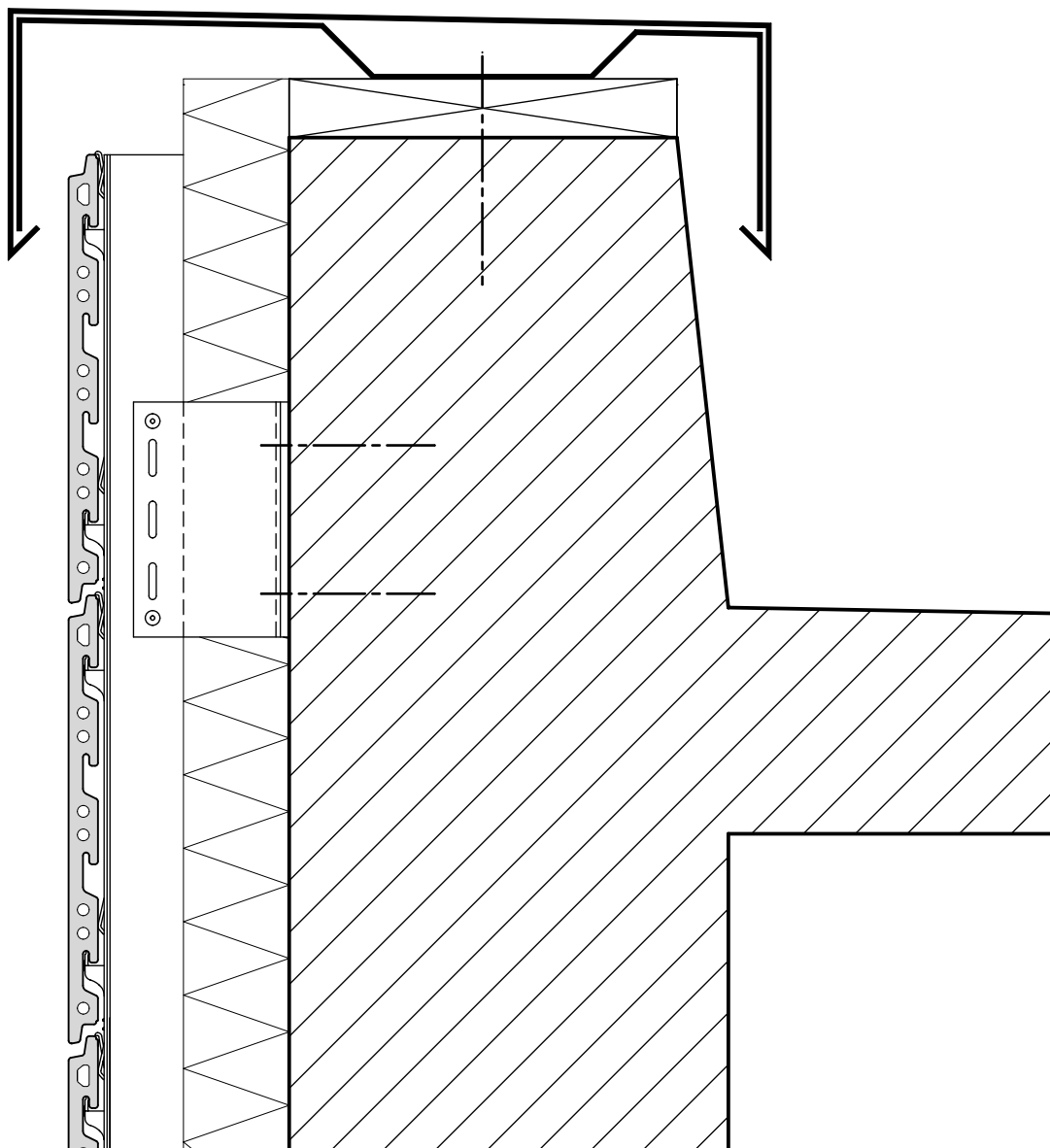

FUGENPROFIL

JOINT PROFILE
PROFILE A JOINTS

KeraTwin® K20

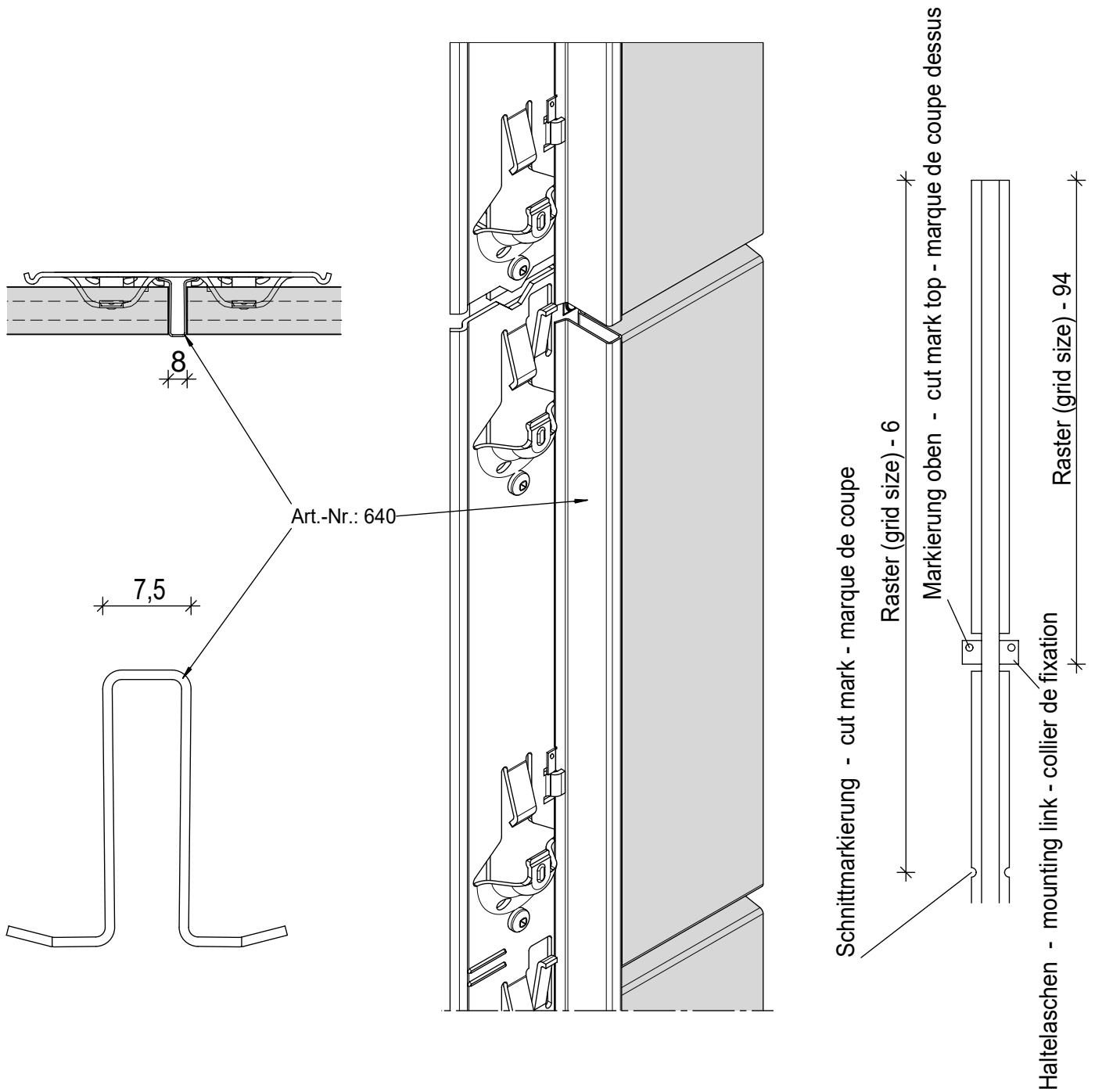

FUGENSTECKPROFIL

JOINT PLUG IN PROFIL

PROFILÉ DE JOINT POUR CLIPPAGE

KeraTwin® K20

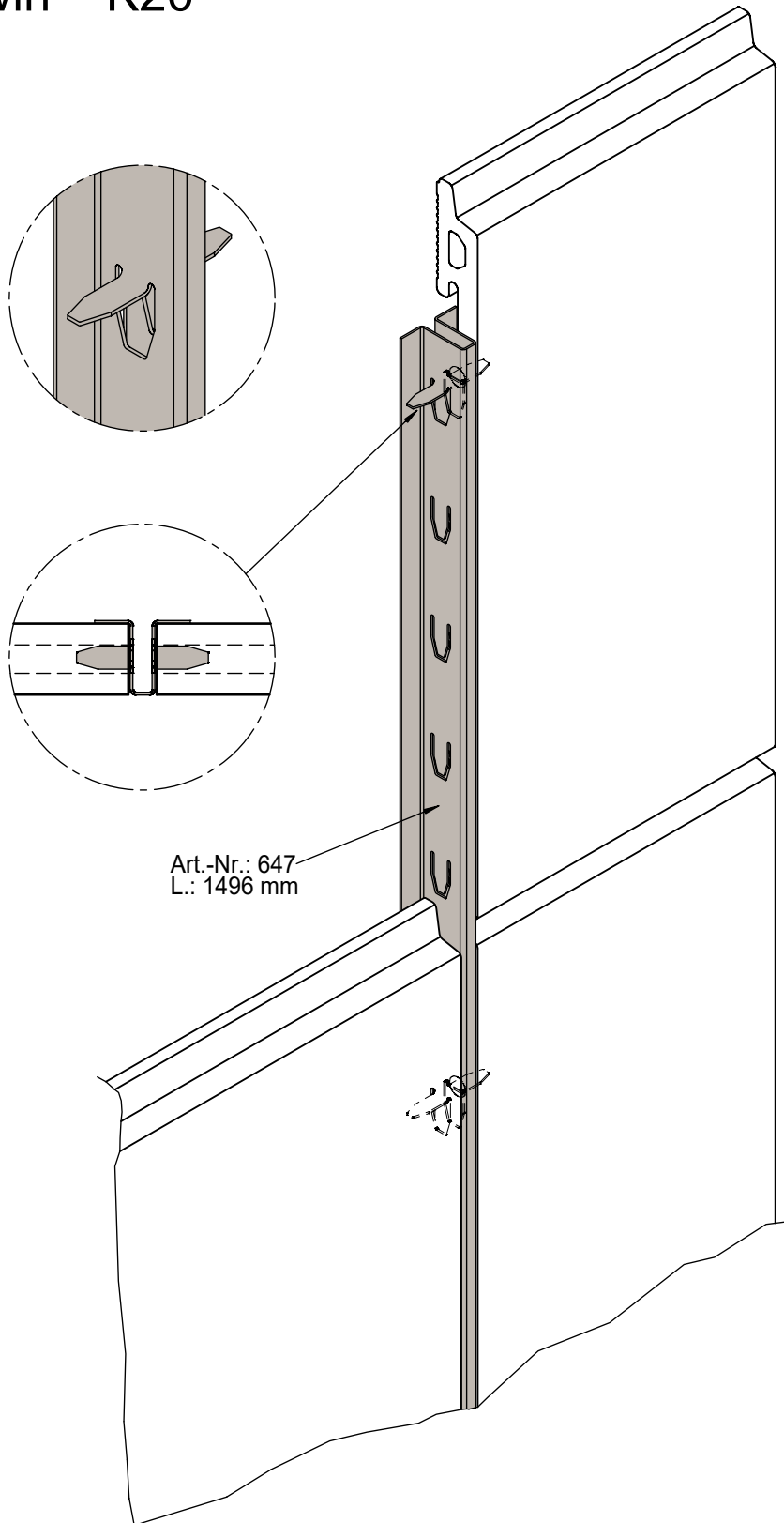

Art.-Nr.: 647
L.: 1496 mm

SYSTEMSCHNITT HORIZONTAL Einfeldträger mit beidseitigem Kragarm

HORIZONTAL SECTION Single-span girder with cantilever on both sides

COUPE HORIZONTALE Poutre mono-travée avec cantilever des deux côtés

KeraTwin® K20

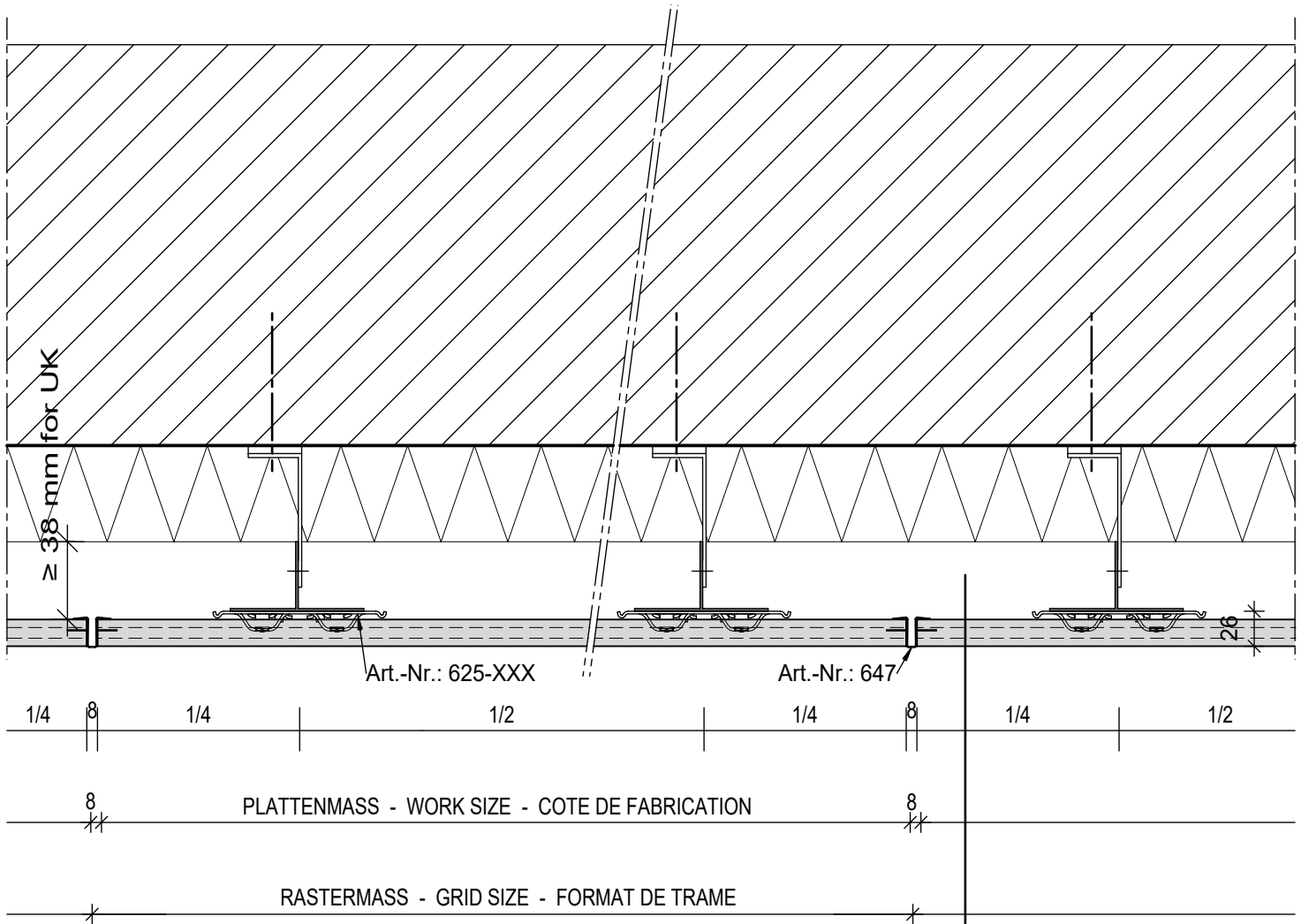

ALTERNATIVE

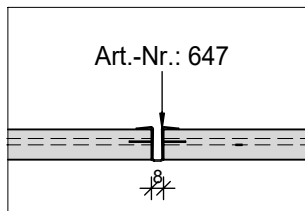

FUGENSTECKPROFIL
PLUG IN PROFIL
PROFILÉ DE JOINT POUR CLIPPAGE

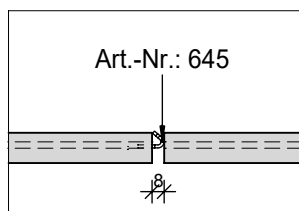

FUGENABSTANDSHALTER
JOINT SPACER
ENTRETOISE DE JOINTS

Note for the UK market:
The air gap has to be
≥ 38 mm

LIEFERLÄNGEN 1 SYSTEMPROFIL K20

LENGTHS SUPPLIED 1 OF SYSTEM RAIL K20

LONGUEURS LIVRABLES 1 DU PROFILE SYSTEME K20

KeraTwin® K20

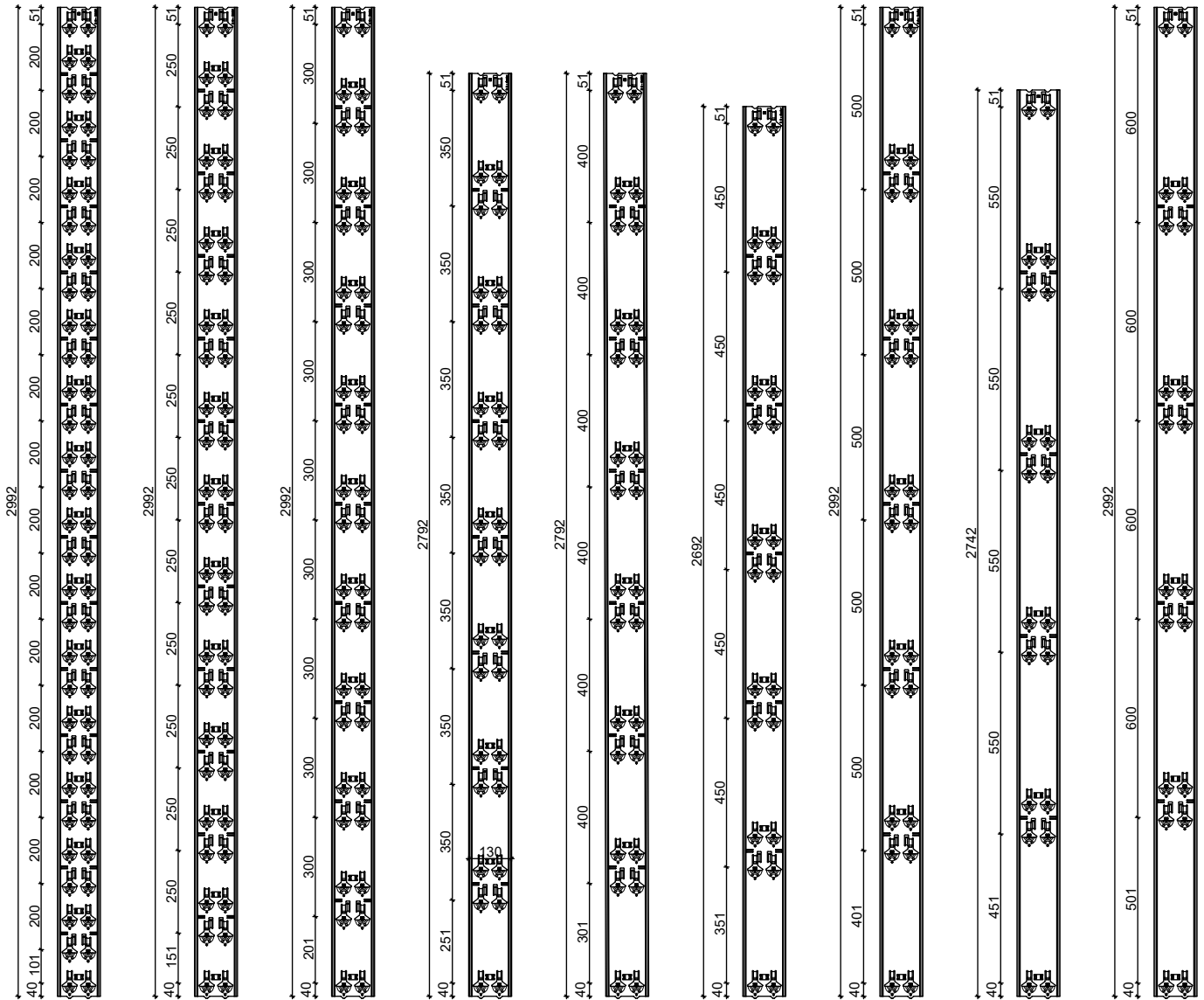

RASTER 20,0 cm RASTER 25,0 cm RASTER 30,0 cm RASTER 35,0 cm RASTER 40,0 cm RASTER 45,0 cm RASTER 50,0 cm RASTER 55,0 cm RASTER 60,0 cm
15 REIHEN 12 REIHEN 10 REIHEN 8 REIHEN 7 REIHEN 6 REIHEN 6 REIHEN 5 REIHEN 5 REIHEN

Art.-Nr.: 620-XXX beschichtet / painted / coloré

Art.-Nr.: 625-XXX unbeschichtet / bright / métallique

DEUTSCHE STEINZEUG **AGROB BUCHTAL** AGROB BUCHTAL GmbH Architektenservice D - 92521 Schwarzenfeld
Tel. 09435 / 391 3238 e-mail: as.fassade@deutsche-steinzeug.de

STAND: Mai 2019

DIES SIND UNVERBINDLICHE KONSTRUKTIONSVORSCHLÄGE, DIE FÜR JEDES PROJEKT AUF ANWENDBARKEIT UND RICHTIGKEIT GEPRÜFT WERDEN MÜSSEN.
THESE ARE NOT BINDING CONSTRUCTION PROPOSALS WHICH HAVE TO BE VERIFIED FOR EACH INDIVIDUAL PROJECT AS REGARDS APPLICABILITY AND CORRECTNESS.
IL S' AGIT DE PROPOSITIONS DE CONSTRUCTION SANS ENGAGEMENT DE NOTRE PART QUI DOIVENT ETRE VERIFIEES POUR CHAQUE PROJET A LEUR EXACTITUDE ET FAISABILITE.

LIEFERLÄNGEN 2 SYSTEMPROFIL K20

LENGTHS SUPPLIED 2 OF SYSTEM RAIL K20

LONGUEURS LIVRABLES 1 DU PROFILE SYSTEME K20

KeraTwin® K20

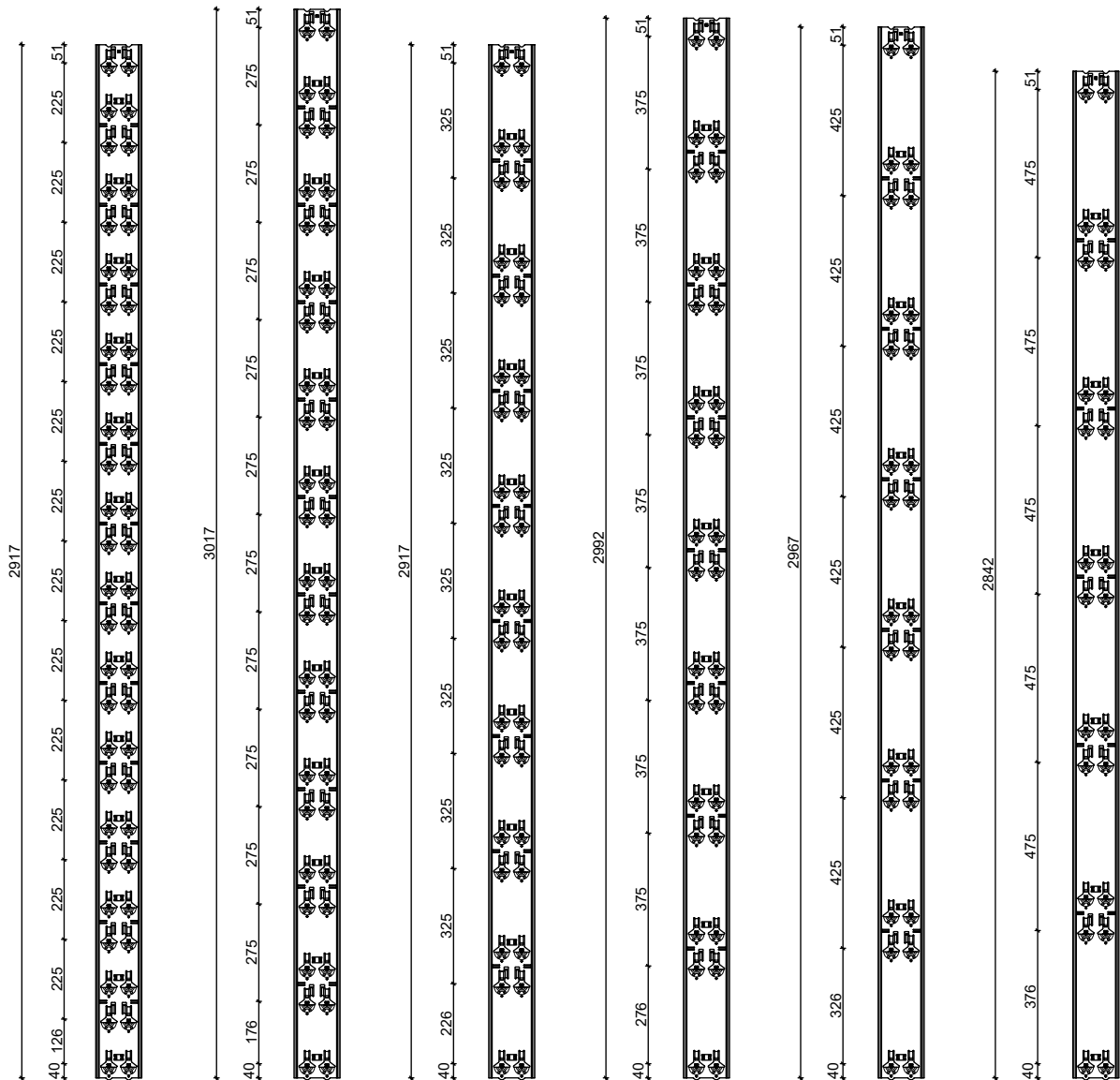

RASTER 22,5 cm

13 REIHEN

RASTER 27,5 cm

11 REIHEN

RASTER 32,5 cm

9 REIHEN

RASTER 37,5 cm

8 REIHEN

RASTER 42,5 cm

7 REIHEN

RASTER 47,5 cm

6 REIHEN

Art.-Nr.: 620-XXX beschichtet / painted / coloré

Art.-Nr.: 625-XXX unbeschichtet / bright / métallique

DEUTSCHE
STEINZEUG

AGROB BUCHTAL

AGROB BUCHTAL GmbH Architektenservice D - 92521 Schwarzenfeld
Tel. 09435 / 391 3238 e-mail: as.fassade@deutsche-steinzeug.de

STAND: Mai 2019

DIES SIND UNVERBINDLICHE KONSTRUKTIONSVORSCHLÄGE, DIE FÜR JEDES PROJEKT AUF ANWENDBARKEIT UND RICHTIGKEIT GEPRÜFT WERDEN MÜSSEN.
THESE ARE NOT BINDING CONSTRUCTION PROPOSALS WHICH HAVE TO BE VERIFIED FOR EACH INDIVIDUAL PROJECT AS REGARDS APPLICABILITY AND CORRECTNESS.
IL S' AGIT DE PROPOSITIONS DE CONSTRUCTION SANS ENGAGEMENT DE NOTRE PART QUI DOIVENT ETRE VERIFIEES POUR CHAQUE PROJET A LEUR EXACTITUDE ET FAISABILITE.